



The Homes Group are delighted to offer this refurbished, ground floor studio maisonette which is located within close proximity of Dartford Town Centre and Train Station. The current owners have renewed the kitchen, shower room, the heating, flooring and freshly decorated the entire property too.

The maisonette has its own front door that leads into the 17'10 x 10'1 studio room which has a large double glazed bay window to the front. The kitchen has wall and base units to three sides with a built in electric oven and hob plus the fridge freezer and washing machine will remain. From the studio room is a door to an inner lobby which leads into the shower room and has doors to a large storage cupboard and the airing cupboard.

The property has one allocated parking space and is offered with no forward chain.

Lease extended in June 2022 to 154 years with 151 remaining and is subject to: £60 per annum ground rent. This is fixed for the terms of the current lease. £700 a year current service charge. All details to be verified by sellers solicitor.

**Knights Manor Way, Dartford, DA1 5SH**  
**Guide price £150,000**

**Studio Room**  
17'10 x 10'1 (5.44m x 3.07m)

**Kitchen**  
7'2 x 6'7 (2.18m x 2.01m)

**Inner Lobby**

**Shower Room**

**Parking**

**Tenure - Leasehold**

**Council Tax - Band A**

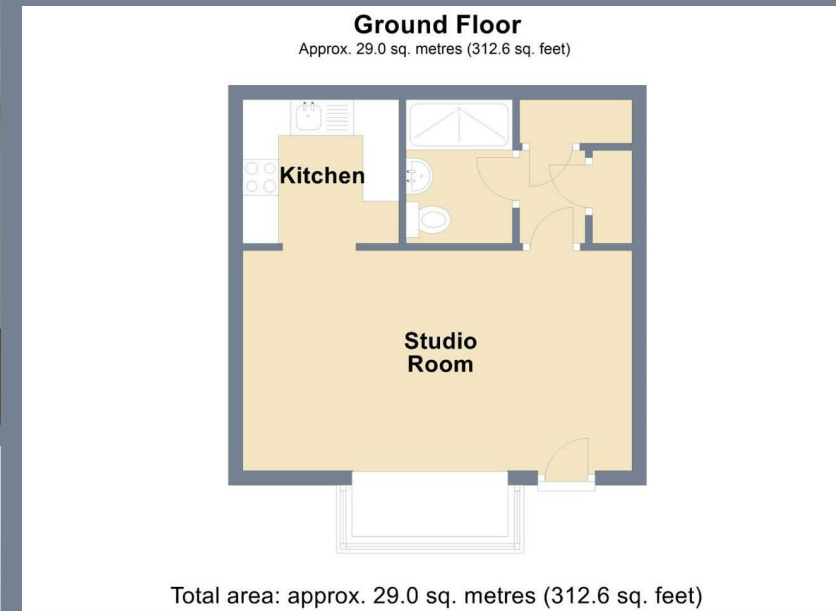

Lease extended in June 2022 to 154 years with 151 remaining.

£60 a year ground rent. This is fixed for the terms of the current lease. - details to be verified by sellers solicitor.

£700 a year service charge. - details to be verified by sellers solicitor.

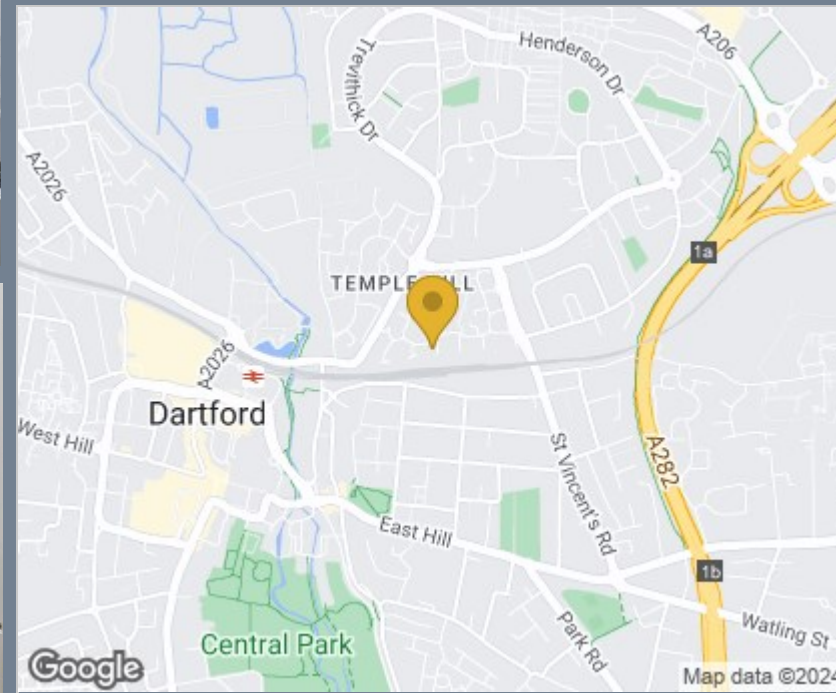

| Energy Efficiency Rating                    |                         |           |
|---|-------------------------|-----------|
|   | Current                 | Potential |
| Very energy efficient - lower running costs |                         |           |
| (92 plus) <b>A</b>                          |                         |           |
| (81-91) <b>B</b>                            |                         |           |
| (69-80) <b>C</b>                            |                         |           |
| (55-68) <b>D</b>                            |                         |           |
| (39-54) <b>E</b>                            |                         |           |
| (21-38) <b>F</b>                            |                         |           |
| (1-20) <b>G</b>                             |                         |           |
| Not energy efficient - higher running costs |                         |           |
|   | 78                      | 82        |
|   | EU Directive 2002/91/EC |           |
| <b>England &amp; Wales</b>                  |                         |           |

71-75 Shelton Street, London, WC2H 9JQ  
T: 01322 875000 | E: info@thehomesgroup.co.uk  
thehomesgroup.co.uk

These particulars, whilst believed to be accurate are set out as a general outline only for guidance and do not constitute any part of an offer or contract. Intending purchasers should not rely on them as statements of representation of fact, but must satisfy themselves by inspection or otherwise as to their accuracy. No person in this firm's employment has the authority to make or give any representation or warranty in respect of the property.